



# QUICK START GUIDE

# BMX

For Following Models

## HERITAGE / BIG WHEEL

Pro Performer 29  
Pro Performer 29: The Mandalorian Edition  
Pro Performer 26  
Pro Performer 20  
Performer 29

Pro Series 29  
Pro Series 26  
Pro Series 24  
Dyno Pro Compe 29  
Dyno Pro Compe 24

## FREESTYLE

Team Signature  
Performer  
Slammer  
Fueler  
Air



# WELCOME TO THE GT FAMILY

Ok, let's get to the point.... We want to get you out riding your new GT. Our simple assembly process makes it possible to use your skills to assemble your GT on your own, and it's even easier to do with a friend. This guide will walk you through the steps, and you can also follow along with a video as you build your bike

**visit:** [support.gtbicycles.com/hc/en-us/articles/1500004114981-BMX-Bike-Assembly](https://support.gtbicycles.com/hc/en-us/articles/1500004114981-BMX-Bike-Assembly)

Contact us at [sales@gtbicycles.com](mailto:sales@gtbicycles.com) if you need some tips or check in with your local bike shop.

Don't forget to tag #gtbicycles in your social media when your new bike is all assembled and ready to ride. We can't wait to check it out.



This is a Quick Start Guide, not an Owner's manual.

Bicycling is an active sport with inherent risk. A wide range of injuries are possible. Due to the nature of bicycle riding, the situations you encounter while riding, you will be exposed to the risk of serious injury, paralysis or death. This risk cannot be eliminated. You can minimize the risk in many ways. Begin by reading the complete GT Bicycle Owner's manual accompanying this bike and available online at [www.gtbicycles.com](http://www.gtbicycles.com).



# THE 4 MAJOR STEPS TO GETTING YOUR BIKE READY TO RIDE



**1. INSTALL HANDLEBARS**

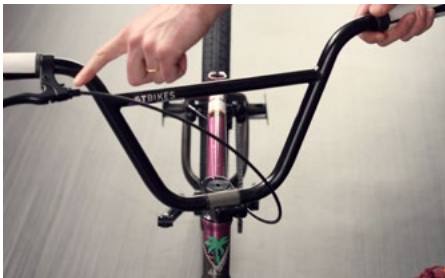

**SETUP**

**2. INSTALL SEATPOST**



**STEP 1**

**3. INSTALL FRONT WHEEL**

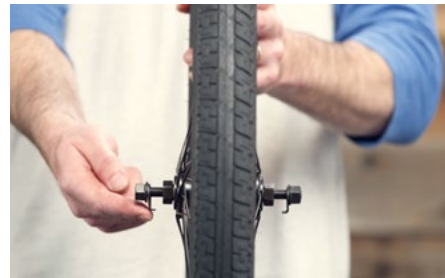

**STEP 2**

**4. INSTALL PEDAL**



**STEP 4**

**CONGRATS!**

# GETTING YOUR BIKE READY FOR ASSEMBLY

- + This assembly video applies to multiple BMX freestyle platforms.
  - Freestyle Team Signature Models
  - Freestyle Team Comp Models
  - Freestyle Team Models
  - Freestyle Performers
  - Slammers
  - Airs
- + Open the box with a screwdriver. Be careful of the staples.

Inside the box, you'll find a smaller box of parts, tools and manuals. Once you have assembled the bike, but before you ride, please read the owner's manual.

- + Remove the front wheel from the packaged bike by removing the zip ties or velcro. Then remove all additional packaging.

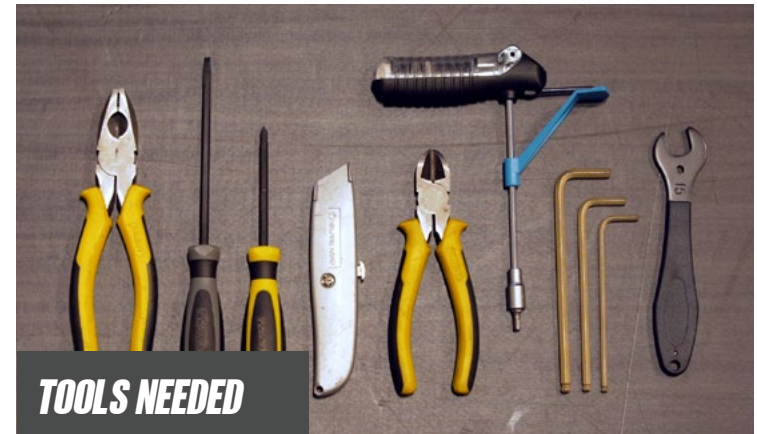

## TOOLS NEEDED

- Pliers or Screwdriver
- Philips head Screwdriver
- Boxcutter
- Cable Cutters or Scissors
- Torque Wrench
- Allen keys
- Pedal Wrench



# KEY PARTS OF THE BIKE REFERENCED IN THIS GUIDE



## STEP 1

# INSTALL HANDLEBARS

1. Remove the four bolts that connect the face plate to the stem. The stem connects the handlebars to the steerer tube of the bike fork.
2. Take your bars and place them on top of the stem. Make sure the brake line crosses the front of the bike and reattaches to the fork on the left-hand side.
3. Center the bars on the stem and install the stem faceplate. Hand-tighten the faceplate bolts into the stem. Make sure your bars are in line with your fork.
4. Using the end of the Allen key, hand-tighten the bolts in an "X" pattern, crossing over the bar each time until the bolts are snug, not tight. You will tighten it to the proper torque later. Ensure the gap between the faceplate and stem is equal all the way around.

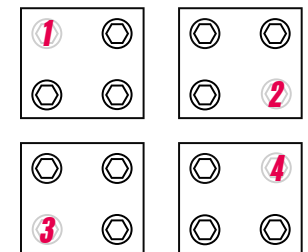
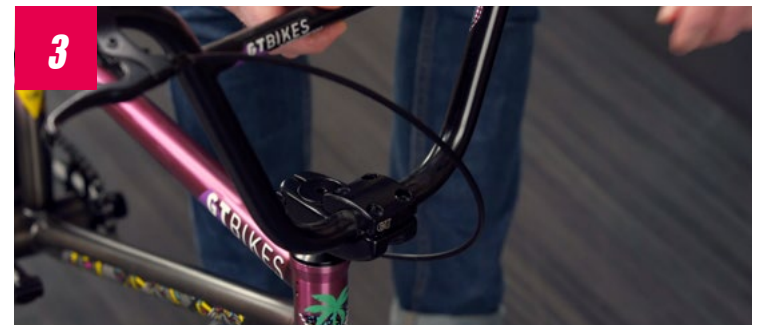



## STEP 2

# INSTALL SEATPOST

1. Install the seatpost into the frame. Locate the minimum insertion line and be sure to insert the seatpost beyond this line. Straighten and align the seat in line with the top tube.
2. Tighten the seat collar snugly for now. It will be tightened to the proper torque spec later.
3. Locate the bolt in the top of the seat post. Once loose, you may adjust the pitch of the seat to your preference. Then, hand-tighten the bolt to the point where the Allen key leaves an impression on your hand.

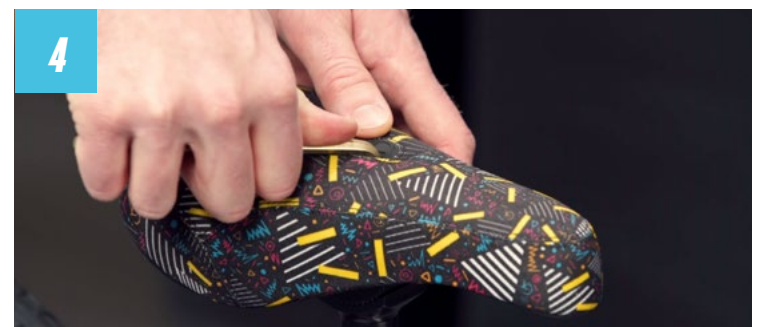

## STEP 3

# INSTALL FRONT WHEEL

1. Remove the fork protector packaging.
2. On the bolt-on axle you will see tab washers and axle nuts. Thread the nuts towards the end of the axle. Move the washers to make room for the dropouts.
3. Place the fork dropouts onto the axle, between the nut, the washer, and the fixing nut.

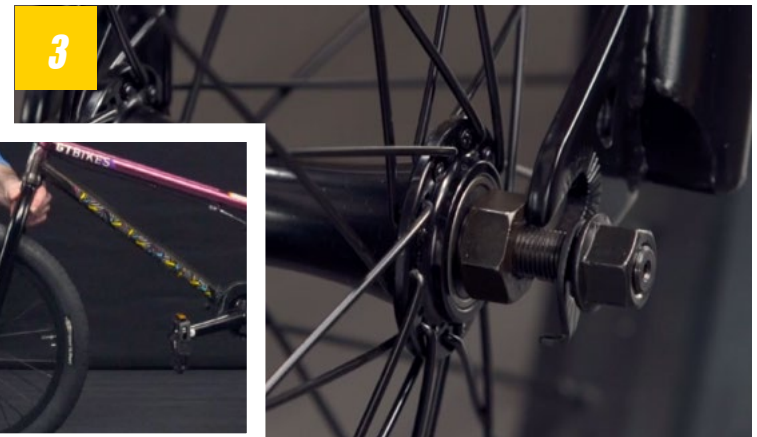
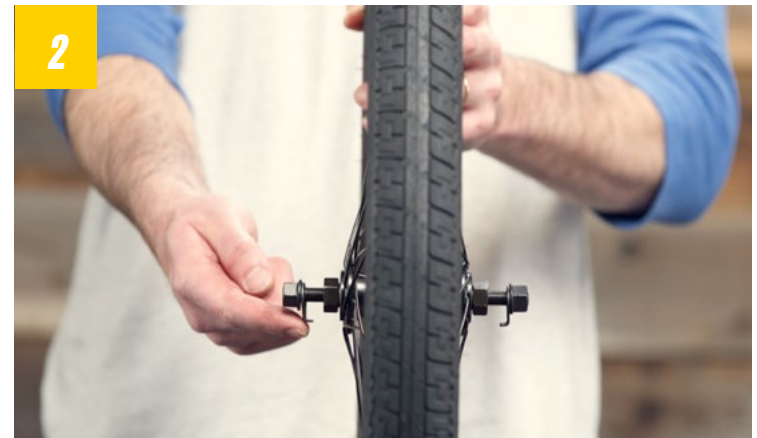



4. Place the tab washer into the opening on the bottom of the fork, and hand-tighten the nut against the tab washer. Repeat the process on the other side of the fork.
5. Turn clockwise – “righty-tighty” with a wrench. It is very important to tighten both axle nuts tightly.
6. Thread on the plastic protectors.

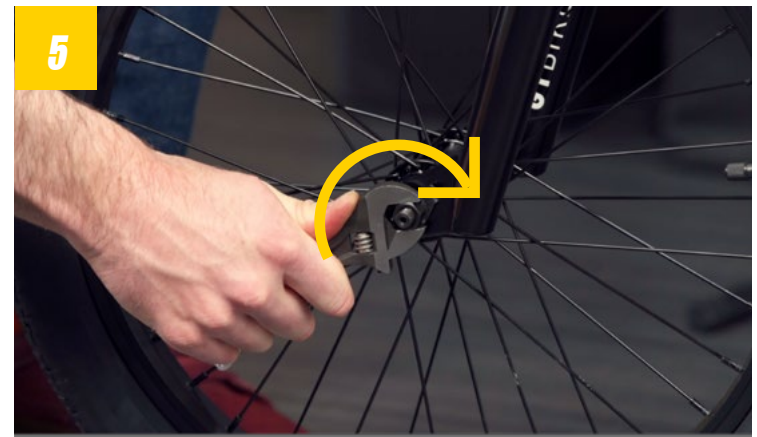
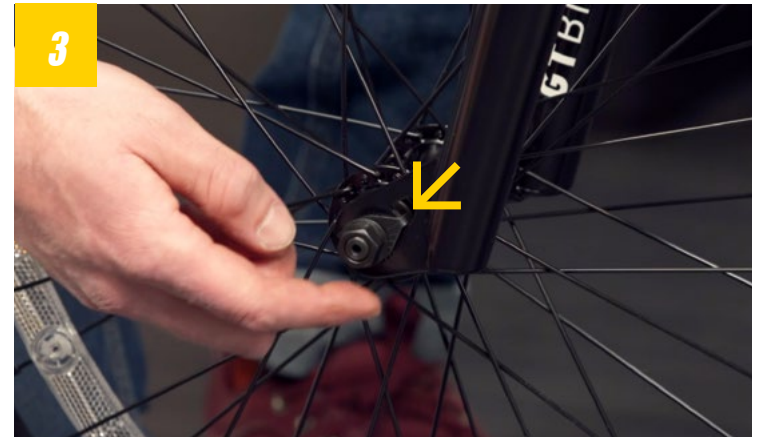

## STEP 4

# INSTALL PEDALS

1. Install the pedals. Locate the left and right stickers on the crank, and also on the pedals. Screw the pedals in the direction of the front wheel. Tighten both pedals very firmly using the pedal wrench included in the box.

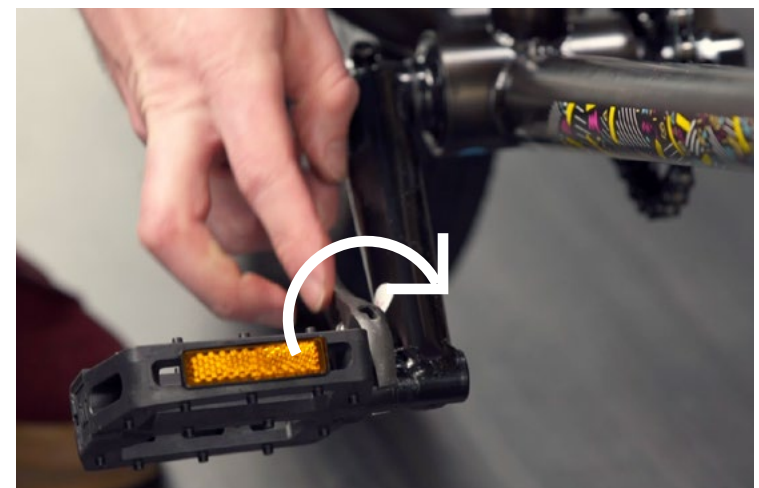

**CONGRATULATIONS!**

# YOUR NEW GT BIKE IS NOW ASSEMBLED

*BEFORE YOU RIDE, IT'S IMPORTANT TO PERFORM A FEW PRE-RIDE CHECKS.*

Make sure your reflectors are tight and positioned correctly. The rear must point straight back, and the front must be perpendicular to the ground.

1. Use the provided torque wrench to tighten the fastening bolts. First select the correct Allen bit and fit to the torque wrench. Look for the torque specification mark on the front and back of the stem, and also on seat post collar, and tighten each to spec. Secure the front wheel between your legs and twist the handlebars. If the handlebars and the front wheel move independently, your stem fixing bolts (at the fork steerer) are not tight enough. Next, push down on the handlebar. It must not move. If it does, tighten the stem faceplate bolts.
2. Inflate the tires to the manufacturer's recommended pressure, marked on the side wall of the tire.
3. Give the bike a final bounce to make sure nothing is loose.

*HAVE FUN!*

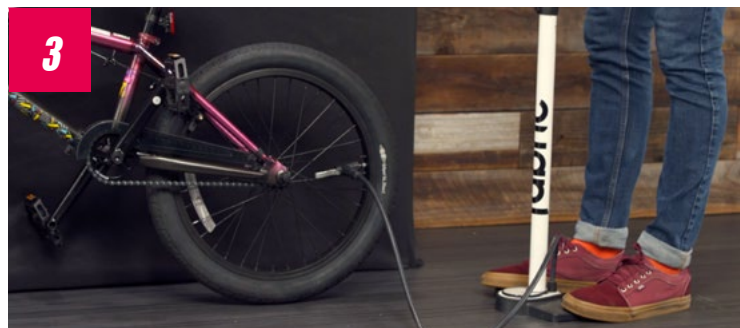



# OUR STORY

Since 1972 GT Bicycles has proudly been developing bikes, for every type of rider, with a consistent mission. That mission is the same reason everybody throws a leg over their very first bike – pure fun, plain and simple. GT Bicycles remains true to sharing the stoke on two wheels which the brand was founded on because, after all, you can't have Good Times without 'GT'!

*FOLLOW US ON*   

@gtbicycles / @gtbmxfreestyle



# REGISTER YOUR BIKE

Visit [gtbicycles.com](http://gtbicycles.com) to register your bike and activate your warranty.



[www.gtbicycles.com](http://www.gtbicycles.com)

